



*jordan fishwick*

Buxton Road Furness Vale High Peak





## Buxton Road Furness Vale High Peak SK23 7PZ

£260,000



### The Property

Most charming and truly deceiving! Superbly presented throughout with incredible views over countryside, a three bedroom, stone built end of terrace. Arranged over three floors and comprising: living room, separate dining room with French doors to a balcony, fitted kitchen, two first floor bedrooms and bathroom, second floor master bedroom with en-suite shower and Juliet balcony. Pvc double glazing, gas central heating and delightful cottage garden laid to lawn. Close to Furness Vale railway station with direct line to Manchester Piccadilly. Viewing highly recommended.





- Fine Rear Views
- Convenient Location
- Deceptive Accommodation
- Three Bedrooms
- Over Three Floors
- Contemporary Glass Balconies
- Living Room Plus Dining Room
- Lawn Garden
- Master Bedroom With En-Suite

Postcode

SK23 7PZ

EPC Rating

D

Local Authority

High Peak

Council Tax

A

Energy Efficiency Rating		
	Current	Potential
Very energy efficient - lower running costs		
(92 plus) A	66	86
(81-91) B		
(69-80) C		
(55-68) D		
(39-54) E		
(21-38) F		
(1-20) G		
Not energy efficient - higher running costs		
England & Wales		
EU Directive 2002/91/EC		
		



GROUND FLOOR

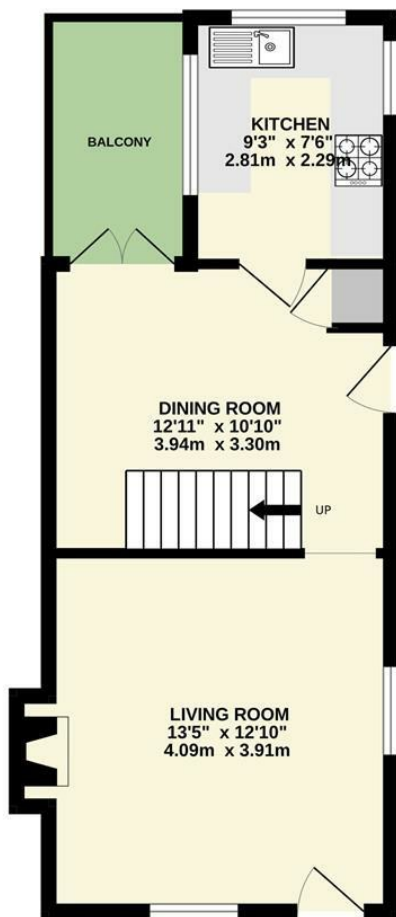

1ST FLOOR

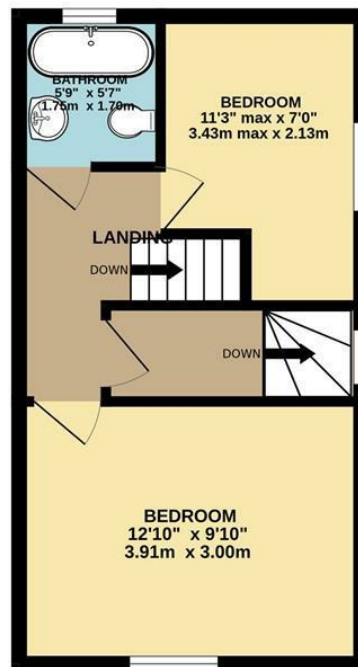

2ND FLOOR

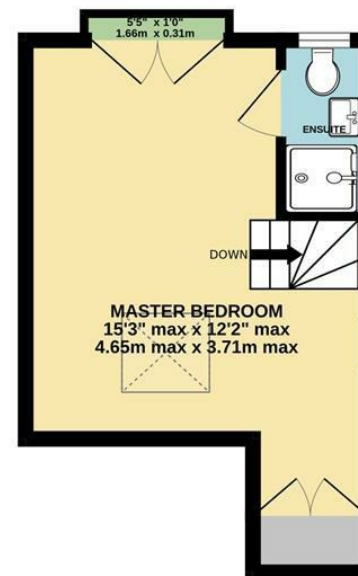

Whilst every attempt has been made to ensure the accuracy of the floorplan contained here, measurements of doors, windows, rooms and any other items are approximate and no responsibility is taken for any error, omission or mis-statement. This plan is for illustrative purposes only and should be used as such by any prospective purchaser. The services, systems and appliances shown have not been tested and no guarantee as to their operability or efficiency can be given.  
Made with Metropix ©2023



These particulars are believed to be accurate but they are not guaranteed and do not form a contract. Neither Jordan Fishwick nor the vendor or lessor accept any responsibility in respect of these particulars, which are not intended to be statements or representations of fact and any intending purchaser or lessee must satisfy himself by inspection or otherwise as to the correctness of each of the statements contained in these particulars. Any floorplans on this brochure are for illustrative purposes only and are not necessarily to scale.

Offices at: Chorlton, Didsbury, Disley, Hale, Glossop, Macclesfield, Manchester Deansgate, Manchester Whitworth Street, New Mills, Sale, Wilmslow and Withington

14 Market Street, Disley, Cheshire, SK12 2AA

**01663 76 78 78**

disley@jordanfishwick.co.uk

www.jordanfishwick.co.uk